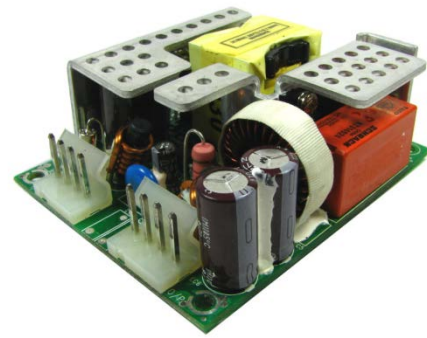

**Features:**

- ◆ Convection Cool, High Efficiency > 85%
- ◆ High Power 60W/Convection
- ◆ OCP , OVP & OTP Protection
- ◆ Mini. Size( L x W x H ) : 78 x 65 x 28mm
- ◆ Can Offer +12V or +24V O/P By Select SW.
- ◆ Wide Operating Ambient Temp. -10 ~ +65°C
- ◆ Safety Compliant With UL60950

**Application:**

- Telecommunication
- Industrial Equipment
- Network , POE

**Safety Certified:****SPECIFICATION**

MODEL		WP113D11	WP113D12 - yy , yy = 12 , 18 , 24		
INPUT	VOLTAGE RANGE	DC Input 48Vdc(38 ~ 57.6Vdc ).			
	FREQUENCY RANGE				
	DC CURRENT (Typ.)	2.0A/38Vdc			
	INRUSH CURRENT (Typ.)				
	POWER FACTOR (Typ.)				
	EFFICIENCY (Typ.)	85%	85%		
	LEAKAGE CURRENT				
OUTPUT	DC VOLTAGE	<b>V1: 12V or 24V(Switchable)</b>	<b>V1 : 12V</b>	<b>V1 : 18.5V</b>	<b>V1 : 24V</b>
	RATED CURRENT <sup>Note1.</sup>	12V / 5A or 24V / 2.5A	5.0A	3.25A	2.5A
	CURRENT RANGE	12V / 0 ~ 5A or 24V / 0 ~ 2.5A	0 ~ 5.0A	0 ~ 3.25A	0 ~ 2.5A
	RATED POWER <sup>Note1.</sup>	60W	60W	60W	60W
	RIPPLE & NOISE (max.)	12V / 120mV , 24V / 240mV	120mV	180mV	240mV
	VOLTAGE ADJ. RANGE	+/- 1V	+/- 1V	+/- 1V	+/- 1V
	VOLTAGE REGULATION	+/- 3%	+/-3%	+/-3%	+/-3%
	SETUP , RISE TIME	≤3,000mS,100mS	≤3,000mS,100mS	≤3,000mS,100mS	≤3,000mS,100mS
HOLD UP TIME (Typ.)					
PROTEC-TION	OVER LOAD	110 ~ 150%	110 ~ 150%	110 ~ 150%	110 ~ 150%
	OVER VOLTAGE	110 ~ 120%	110 ~ 120%	110 ~ 120%	110 ~ 120%
	OVER TEMPERATURE				
FUNCTION	5V STANDBY& 12Vaux				
	DC OK SIGNAL				
	REMOTE CONTROL				
	PARALLEL OPERATION				
ENVIRON-MENT	WORKING TEMP.,HUMIDITY	-10 ~ +65°C , 10 ~ 85%RH non-condensing			
	STORAGE TEMP.,HUMIDITY	-40 ~ +85°C , 5 ~ 95%RH non-condensing			
	TEMP. COEFFICIENT	± 0.03% /°C (0 ~ 50°C)			
	VIBRATION	5 ~ 500Hz, 2Grms, 20 minute for each X, Y, Z axis.			
SAFETY & EMC	SAFETY STANDARDS	UL 60950-1 2nd , EN 60950-1			
	WITHSTAND VOLTAGE	I/P - O/P: 2,000Vrms			
	EMC EMISSION <sup>Note 3.</sup>	Compliance to EN55022(CISPR22) Class B, FCC part 15 Class B, EN61000-3-2,3			
	EMC IMMUNITY	Compliance to EN61000-4-2,3,4,5,6,8,11			
OTHERS	MTBF	100K hrs min. MIL-HDBK-217F (25°C)			
	DIMENSION	78 x 65 x 28mm( L x W x H )			
	PACKING	0.155Kg / pcs , 75pcs / CTN , GW: 13.2Kg , Carton(L x W x H): 435 x 320 x 225mm			
NOTE	1. WP113D11,12 series can provide 60W O/P with convection cooling. 2.The SPS is considered a component which will be installed into final equipment. The equipment must be re-confirmed that it still meets EMC directives. 3. All parameters NOT specially mentioned are measured at rated input, rated load and 25°C of ambient temperature.				

WP113D1x , x = 1 , 2 Series

**Typical Mechanical Drawing:**

WP113D11

Case dimension ( L\*W\*H ):78\*65\*28.1mm

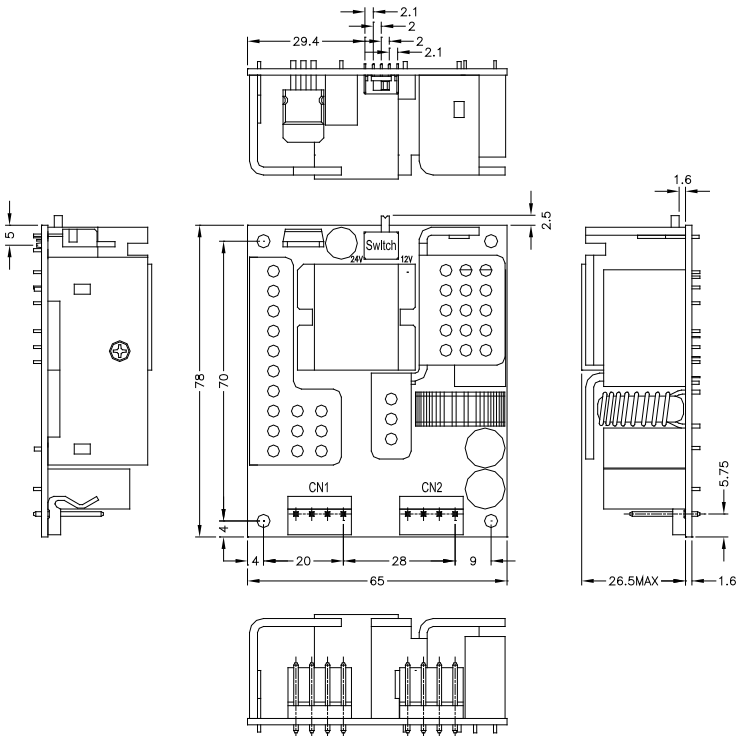

**Connector (CN1) :**

MOLEX 09-65-2048 (5273 SERIES) or EQU  
Mates with MOLEX 09-50-1041 (5239SERIES) or EQU

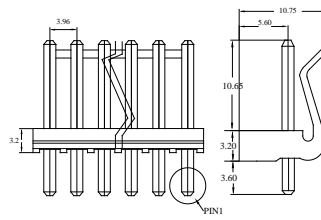

Pin	Signal
1	VI
2	VI
3	PGND
4	PGND

**Connector (CN2) :**

MOLEX 09-65-2048 (5273 SERIES) or EQU  
Mates with MOLEX 09-50-1041 (5239SERIES) or EQU

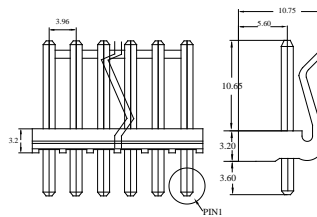

Pin	Signal
1	VO
2	VO
3	S GND
4	S GND

**Switch :**

The switch p/n is SS008-03P-22-Y

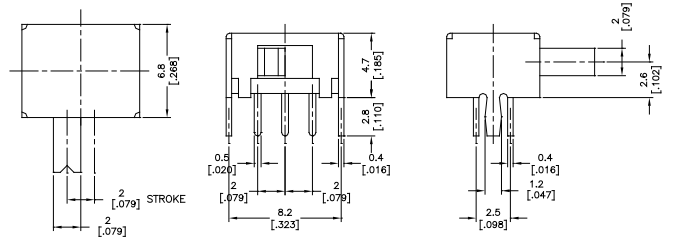

**De-rating Curve :**

**De-rating Curve**

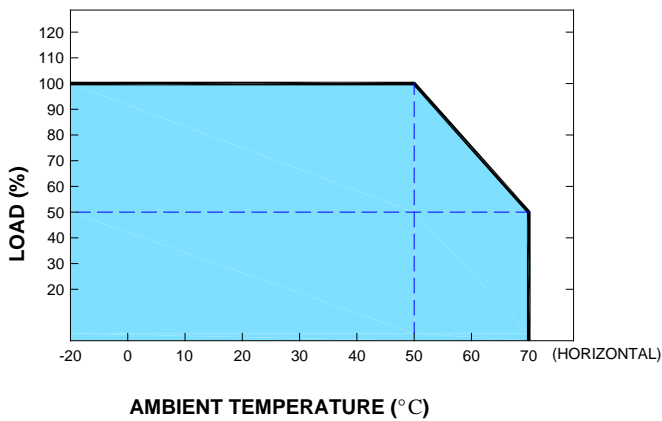

**OUTPUT VOLTAGE DEFINE**

OUTPUT SLECTOR SLIDE SWITCH LOCATION	O/P VOLTAGE
	+12V
	+24V

WP113D1x , x = 1 , 2 Series

**Typical Mechanical Drawing:**

WP113D12

Case dimension ( L\*W\*H ):78\*65\*28.1mm

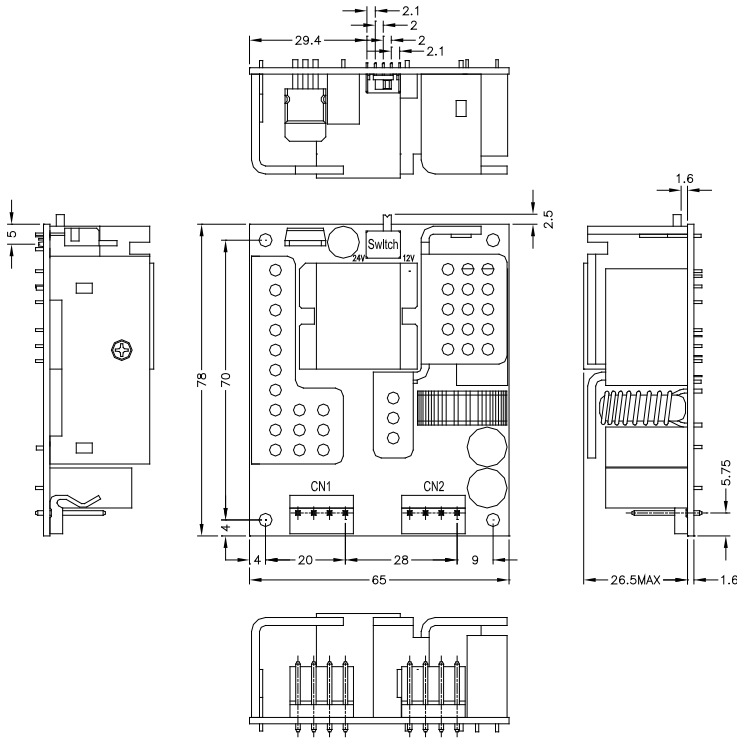

**Connector (CN1) :**

MOLEX 09-65-2048 (5273 SERIES) or EQU  
Mates with MOLEX 09-50-1041 (5239 SERIES) or EQU

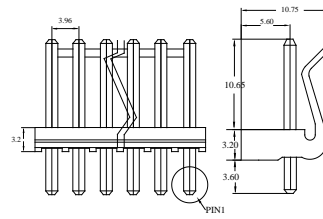

Pin	Signal
1	VI
2	VI
3	P GND
4	P GND

**Connector (CN2) :**

MOLEX 09-65-2048 (5273 SERIES) or EQU  
Mates with MOLEX 09-50-1041 (5239 SERIES) or EQU

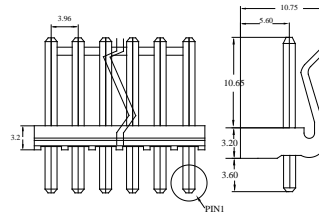

Pin	Signal
1	VO
2	VO
3	S GND
4	S GND

**De-rating Curve :**

De-rating Curve

