

ED1010 Series

DC/DC Switching Converter
• 120Watts Max.



Features

- RoHS Compliance
- Wide Input Range
- Input Voltage Protection Installation
- Over Current Protection Installation
- Over Temperature Protection Installation
- Short Circuit Protection Installation
- 100% Burn-In
- LED Indication
- MTBF: >50,000 hours

ED1010 x YY - vv PP

x: Output range

YY: DC Input Type:

91 for EDACPOWER standard cigarette lighter

vv: Specified output voltage, ie 24 is 24Vdc

PP: Connector type, ie 01 for EDACPOWER standard dc cable or please refer to the appendix page

Electrical Specifications

MODEL No.	MAX. OUTPUT POWER (W)	INPUT VOLTAGE (Vdc)	OUTPUT VOLTAGE (Vo)	LOAD		LOAD REGULATION	LINE REGULATION	RIPPLE & NOISE
				MIN. (Io)	MAX. (Io)			
ED1010A	120W	11~16V	16V	0	7A	± 5%	± 2%	300mV
ED1010B	120W	11~16V	18V	0	6.7A	± 5%	± 2%	300mV
ED1010C	120W	11~16V	19V	0	6.3A	± 5%	± 2%	300mV
ED1010D	120W	11~16V	20V	0	6.0A	± 5%	± 2%	300mV
ED1010E	120W	11~16V	24V	0	5.0A	± 5%	± 2%	300mV

NOTE:

1 : Ripple & noise is measured by using 20MHz bandwidth limited oscilloscope and terminated each output with a 0.1uF ceramic capacitor & parallel with 47uF aluminum capacitor at full load and nominal line.

2 : Max. Output Power (W) ≥ Vo x Io

Electrical Specifications

INPUT

- Input Range 11 to 16 Vdc
- Input Current 12A Max.
- Inrush Current No Damage to relative components
- Efficiency 87% Min. Nominal input

OUTPUT

- Over Current Protection Auto Recovery
- Over Temperature Protection Auto Recovery

ENVIRONMENTAL

- Operating Temperature 0 to 40°C
- Storage Temperature -20 to 85°C
- Storage Humidity 5% to 95%

SAFETY

- e1

Mechanical Specification

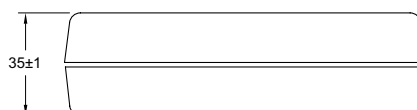
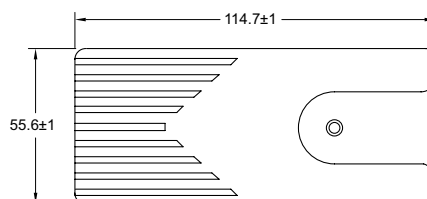

- Case Size: 114.7L x 55.6W x 35H (mm)
- DC Input: Cigarette Lighter with UL1185 dc cable.
- Weight: 300g